



Royale Medical Pro Shift Patient Mover
User Manual

Contents

Section	Title	Page
1	Introduction	2
2	Safety & Precautions	3
3	Transferring the Patient	4
4	Labelling Information	6
5	Features	7
6	Specifications	8
7	Installation	9
8	Product Care & Maintenance	13
9	Warranty	14
10	Quality Assurance	15
11	Recycle & Disposal	15

No part of this user manual may be copied, distributed, reproduced, duplicated, scanned or stored whether in whole or part in any form or by any means without the expressed written consent from the officers of Independent Living Specialists Pty Ltd. Independent Living Specialists does not accept responsibility for any changes, errors or omissions. All information is subject to change without prior notice and products may vary from that of the actual images depicted.

1 Introduction

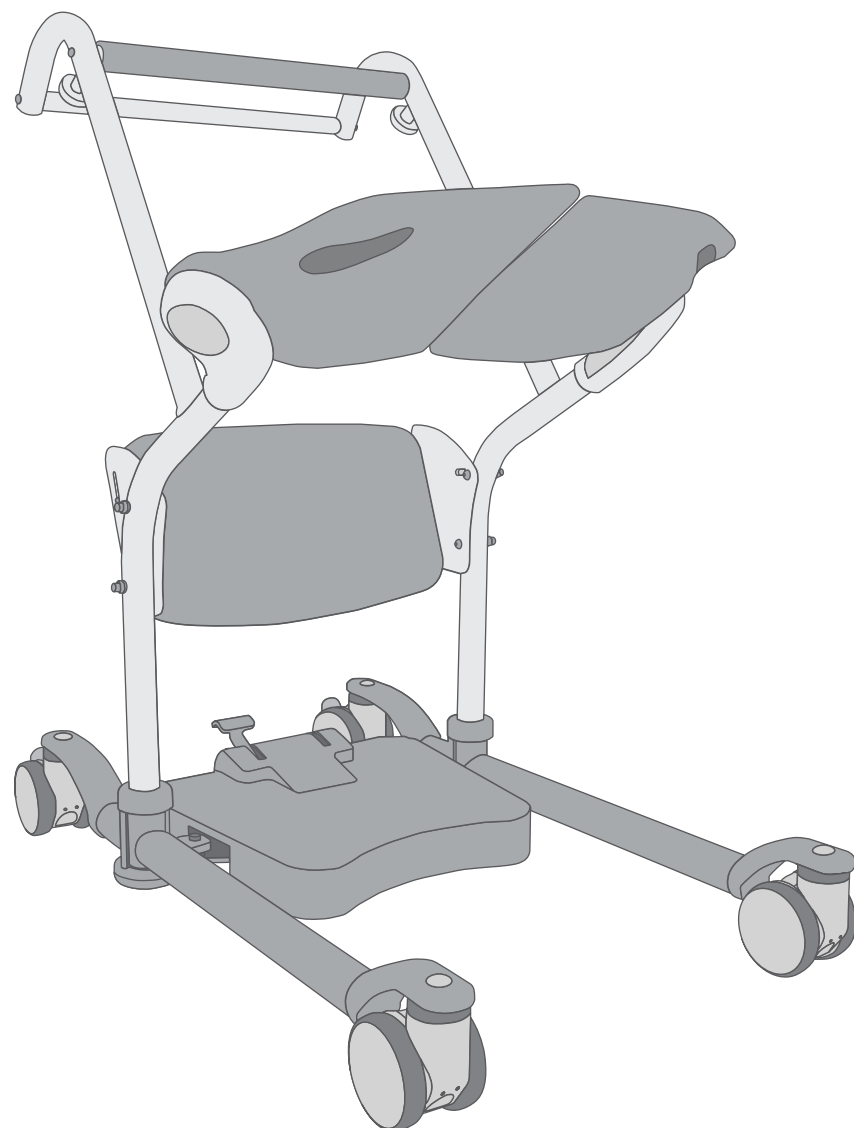

S332019 Patient Transfer – Royale Pro Shift Patient Mover

The Royale Pro Shift Patient Mover is a sit-to-stand transfer aid designed to enable a single caregiver to assist user's to stand and transfer into another seated position. To safely and correctly use this transfer aid, users must:

- Be able to actively push through their lower limbs and weight bear
- Have adequate grip strength to pull themselves into a standing position
- Have adequate core strength to maintain a safe seated posture when resting on the seat pads throughout the transfer
- Have the cognitive ability to follow the directions of the care giver/assistant

Safety & Precautions 2

Risk Assessment – Ensure a risk assessment has been completed. Transferring a person may pose an element of risk, only trained personnel should use this equipment.

Weight Bear – User must be able to weight bear as they are required to stand on the base plate and push themselves into a standing position whilst gripping onto the support handle.

User Safety – Plan transfers in advance to ensure it is performed as safe and smooth as possible. Appropriate footwear must be worn by user and caregiver. Never leave the user unattended on the device.

Indoor Use – Should only be used indoor on flat surfaces, never use on surfaces which could result in the device rolling.

Safe Working Load – Do not exceed the maximum weight limit of 225kg. Ensure the user's weight is centered appropriately. Designed only to transfer users from one seat to another – do not use to porter user or goods.

Caregiver – Ensure base plate remains in contact with the floor at all times during use – do not tilt or lever the device. Ensure the caregiver can safely manage the weight of the user. Caregiver must always support and counterbalance the device whilst in use by a user.

Transferring – If user is transferring into a wheelchair seat or commode seat, ensure the brakes are engaged and leg rests are removed or swung away. Ensure patient transfer device attendee brakes are engaged when device is stationary – Mandatory when user is transferring into a standing or seating position.

Assembly – Ensure all components are mounted and secured correctly and that adjustable components are positioned to suit the users needs.

3 Transferring the Patient

The following details are a guide. Only trained health professionals should provide patient handling advice and a functional and/or user risk assessment must be done prior to use.

- The caregiver should rotate (open) the seat pads outwards to allow the user to access the device.
- The caregiver should position the device under the users feet, allowing the user to place their feet on the marked left and right symbols on the base plate. Caregiver's may need to adjust the legs to improve access around large chairs or other objects.
- Once the user has comfortably positioned both feet, apply both the brake castors.
- The caregiver should encourage the user to grab the user support bar with both hands and transfer into a standing position.
- Once the user is in a secure standing position, the caregiver can rotate (close) both the seat pads.
- The caregiver should ask the user to carefully lower themselves into a seated position.
- Once the user is secure and comfortable, the caregiver can release the brake castors and proceed with the transfer by steering with the attendee push bar towards the new seating position.
- Ensure the new seating position is in a locked position (e.g. wheelchair or commode has brakes engaged).
- Once positioned near the new seat, the user should have their back to the seat and feel the seat edge on the back of their legs. Caregiver's may need to adjust the legs to improve access around large chairs or other objects.
- The caregiver must apply both brake castors and encourage the user to grab the user support bar with both hands and transfer into a standing position.
- Once the user is secure and comfortable, the caregiver can rotate (open) the seat pads outwards to allow the user to exit the device.
- The user should continue to hold onto the user support bar and slowly lower themselves into the new seat.
- Once the user has safely transferred into the new seat, the attendee can release the brakes and carefully remove the device from underneath the users feet.

Transport and Storage

Recommended operating temperature ranges from 5°C to 40°C and storage ranges from -20°C to +80°C

Adjustments to the Knee Pad Support

The knee pad is height and angle adjustable.

Height – To adjust the height, simply loosen the nut and bolt.

Angle – To adjust the angle, simply loosen the nut and bolt. Reposition the knee pad to the required angle and then retighten.

Using a Standing Belt

Certain standing belts may be compatible with the Royale Pro Shift Patient Mover.

Belts that are compatible, it is recommended to hook onto the anchor points on the upper handle component. Please always only use with consultation and assessment by a trained health professional. Please always follow recommendations from the belt manufacturer.

Using the Attendant Brakes

The brakes prevent the device from moving unexpectedly while the user transitions from a seating to standing position or vice versa. The caregiver simply presses down on the locking tab to engage and vice versa. Ensure attendee brakes are engaged when device is stationary – Mandatory when user is transferring into a standing or seating position.

Adjusting the Seat Pads

The seat pads can swing away to allow users to enter the device. Simply hold the seat pad on the corner and pivot away from the transfer area. Once user is comfortable and ready to perch, simply pivot the seat pads underneath the user. Ensure user holds onto support bar and slowly lowers and raises from the seat pads.

4 Labelling Information

a. Product Label

The Royale Pro Shift Patient Mover has a product label on the side support frame. The product label includes the following information:

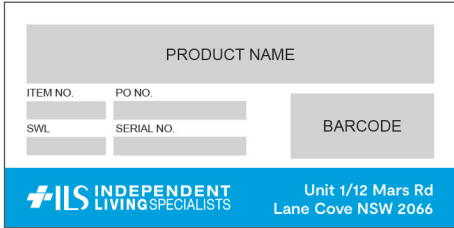

- Name and address of the company
- Name and code for the product
- Safe Working Load (SWL)
- Serial number of the product (which includes the date of manufacture and the batch serial number)

Features 5

- ▶ Easy to manouvere
- ▶ Adjustable leg spread for access around furniture
- ▶ Comfortable swing-away seat pads
- ▶ Height and angle adjustable knee pads

6 Specifications

Specifications	S332019
Overall Width (External)	66cm – 94cm
Overall Width (Internal)	50cm – 78cm
Overall Depth	100cm
Overall Height	104cm
Base Plate Height	10cm
Rear Width	55cm
Knee Pad Measurement (W x H)	43cm x 25cm
Knee Pad Height from Base Plate	20cm – 24cm
Handle Height from Base Plate	90cm
Seat Height from Base Plate (B x T)	56cm x 68cm
Seat Width	58cm
Seat Depth	31cm
Front Castors	10cm
Rear Castors (w/brakes)	10cm
Underbed Clearence	15cm
Attendee Push Handle Height from Floor	104cm
Safe Working Load (SWL)	225kg

Installation 7

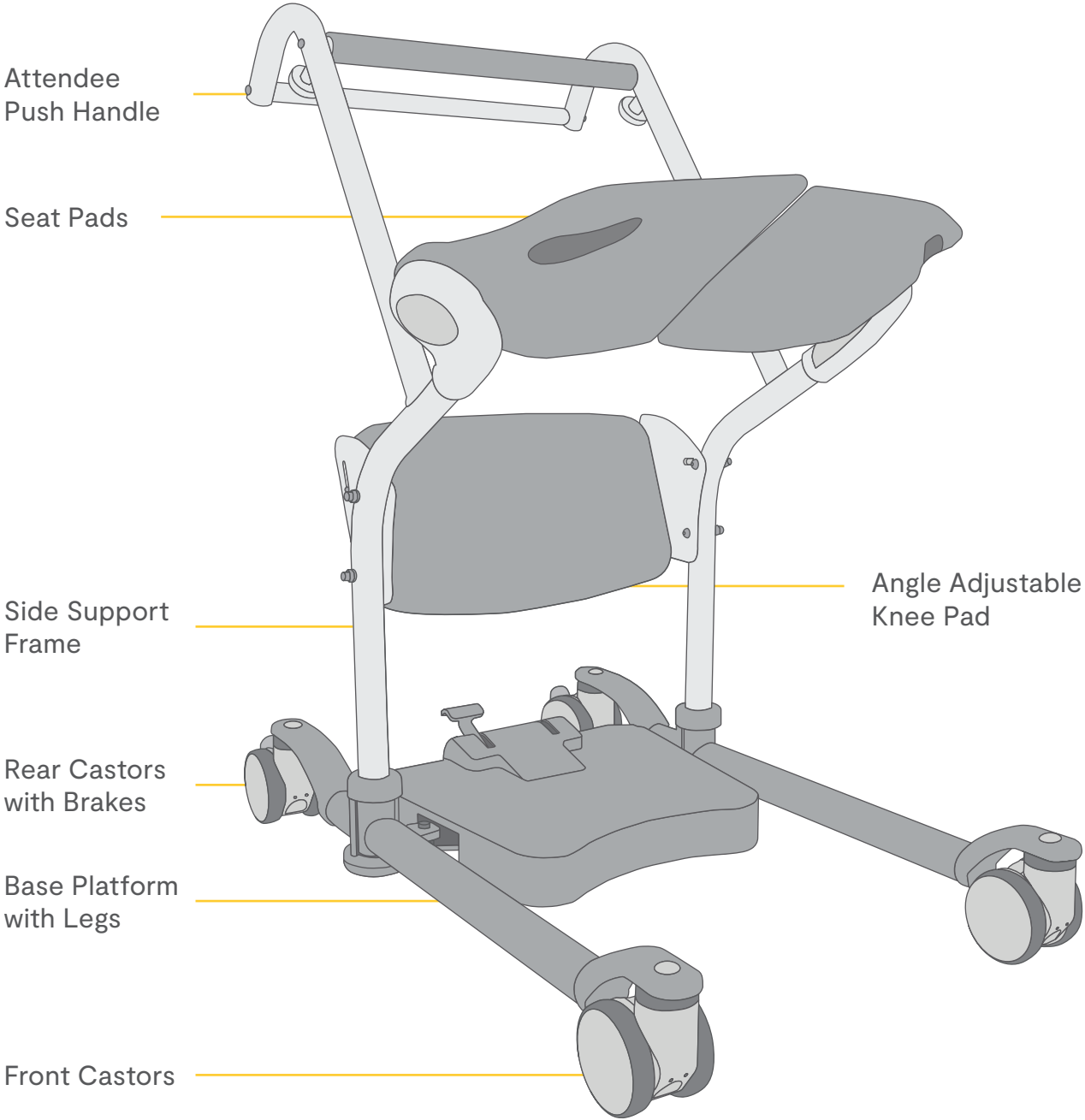

Assembly

- The patient transfer aid comes with the above components: base platform with legs, side support frame (pair), push handle assembly, knee pad, hand screws, washers, screws and bolts.

Assembly

Positioning the base platform and push handles

- Apply the push handle and seat pad assembly into the left and right hand sides of the base platform, using the covers.
- Secure the push handle and seat pad assembly to the base platform by inserting screws and tighten using the hex key. Refer to Figure A.
- Secure the bottom of the base using screw pad and screws and tighten using the hex key. Refer to Figure A. (Please note: May need to turn unit on it's side to access)
- Repeat steps for both left and right sides.

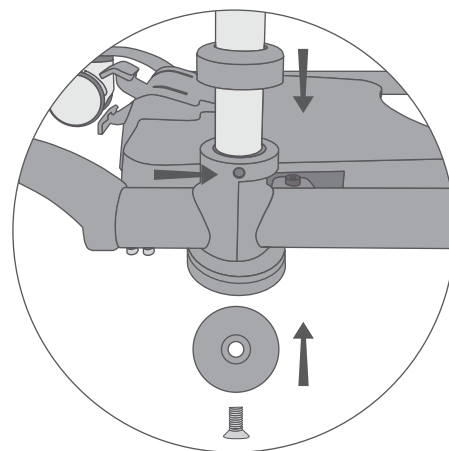
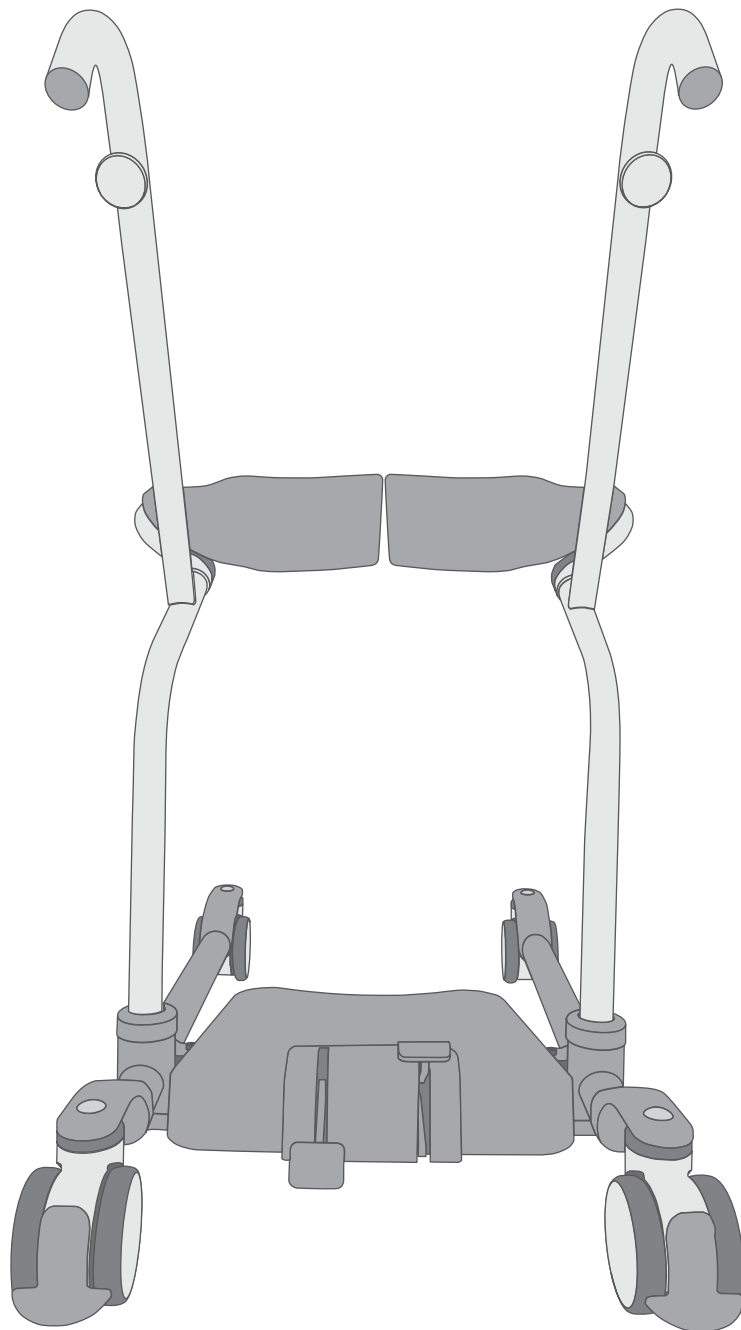

Figure A. Securing the push handle and bottom of the base

Assembly

Securing the knee pad

- Secure the smaller washer and screws to the bottom holes of the knee pad assembly and tighten using the hex key. Complete for both left and right bottom holes.
- Secure the larger washer and hand screw to the top holes of the knee pad assembly and tighten. Complete for both left and right bottom holes. Refer to Figure B.

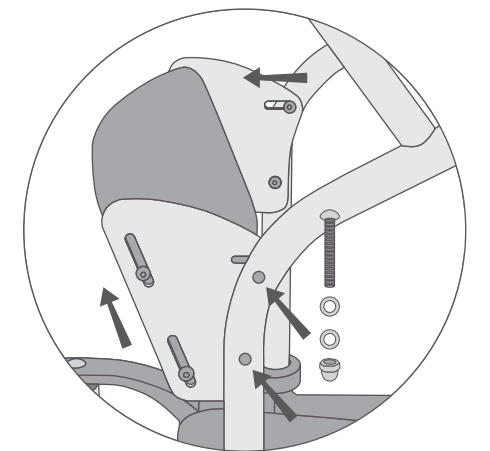

Figure B. Securing the knee pad

Assembly

Securing the attendee push handle and user support handle

- Secure the push bar to the push handle using the screws and tighten using the hex key. complete for both left and right sides. Refer to Figure C.
- Repeat steps for the user support bar.

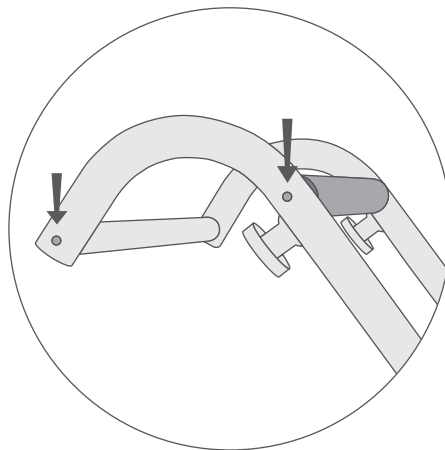
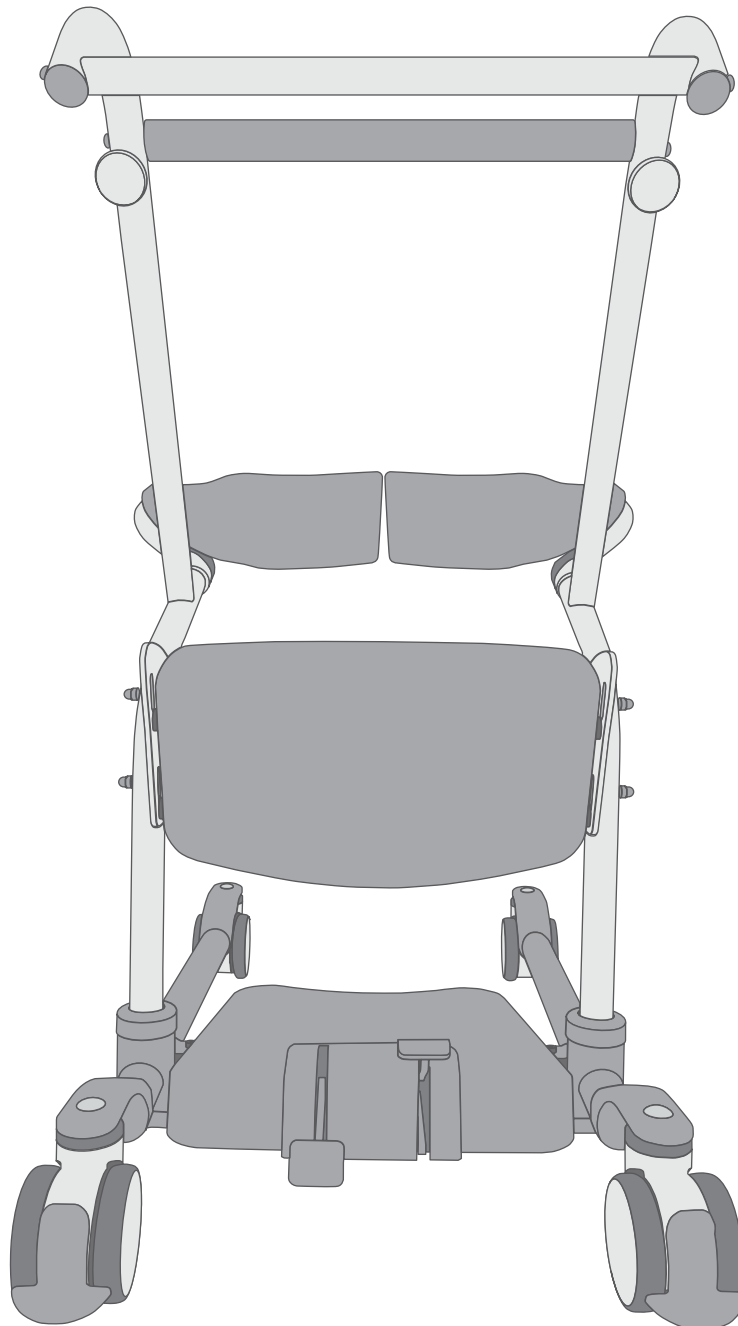

Figure C. Securing the attendee push handle and support handle

Product Care & Maintenance

8

1. It is recommended that the patient transfer device is inspected regularly for signs of wear and tear of the base plate, rear castors, lower leg support, knee pad and upper handle support.
2. If there are visible signs of wear and tear, please contact your authorised dealer for replacement parts.
3. Please ensure the seat and knee pads are secure and not loose or damaged.
4. If exposed to water or moisture, simply dry the patient transfer device to prevent corrosion.
5. The patient transfer device should be wiped down regularly using warm water or a mild detergent.
6. Regularly clean your patient transfer device with soft cleaning implements such as soft sponges, dish clothes and soft-bristled brushes. Warning, using strong cleaning liquids or similarly abrasive cleaning products could cause damage to the surfaces of your patient transfer device.
7. Regularly clean the castors with a mild detergent and warm water, removing hair and debris from the castors and check that the castors rotate freely.
8. Regularly check the patient transfer device castors rotate smoothly and are securely fitted.
9. Ensure the attendant brakes engage and disengage as intended. Visually inspect for signs of wear and tear.
10. Ensure all components are tightened and secured.

For all replacement parts as well as after-sales support and repair services are available through Royale Medical dealers.

9 Warranty

The Royale Medical Royale Pro Shift Patient Mover comes with 12 months warranty from the date of purchase on structural integrity.

- During the warranty period any parts that have become defective due to faulty workmanship or material will be repaired or replaced without charge by a Royale Medical dealer of where the product was purchased.
- The warranty is for indoor use only and excludes any defect or injury caused by or resulting from misuse, abuse, neglect, accidental damage, or any other alteration that affects the reliability or performance of the unit, not attributable to manufacturing faults, parts or labour.

PARTS NOT COVERED UNDER WARRANTY:

1. Castors, components and parts that are subject to reasonable wear and tear.
2. Faults that have been identified as misuse or user error.

Note:

- Royale Medical does not warrant any damage which is deemed accidental or as a result of misuse.
- Royale Medical will only provide the required parts under warranty.
- Unauthorised changes or modifications will forfeit your warranty.
- If a defect or fault is discovered, please contact the Royale Medical dealer of where the patient transfer device was purchased.

Quality Assurance 10

ILS is dedicated to providing the highest quality in assistive technology equipment, which is why all our Royale Medical products are registered with the Therapeutic Goods Administration (TGA) and certified to the Australian/New Zealand Standard (AS/NZS).

- ARTG: 393673
- AS/NZS ISO 10535:2011
- AS/NZS 4438:1997 (R2016)

Recycle & Disposal 11

Please follow the local government rules regarding proper recycling and disposal. It should always be done through an authorised agent or licensed place of disposal. Please review the list of patient transfer parts and packaging materials to ensure they are recycled or disposed of correctly.

- Frame: steel
- Base: plastic
- Castors: polyurethane
- Knee Pads: polyurethane
- Seat: polyurethane
- Packaging: cardboard carton and plastic

Please follow the local government rules in regards to the proper disposal and recycling.



Independent Living Specialists
Unit 1, 12 Mars Road
Lane Cove West NSW 2066
1300 008 267 | ilsau.com.au

©2025 ROYALE MEDICAL. INDEPENDENT LIVING SPECIALISTS

PDT055-0525